

Features

- ATEX, IECEX, CNEx, CE, Approved;
- Applicable for Gas Zone 1, Zone 2, Class II A, IIB, IIC, T1-T6 group
Dust Zone 21, 22.
- Certified for the latest standards IEC/EN60079 (2014)
- Stainless steel 304 or 316L enclosure
- Surface optional electro-polished or painting
- Weather Proof IP68(1.2m/45min)
- Wide voltage input: AC100-240V or AC24V
- Strong tempered glass, fit for hydrofluoric acid area
- Intelligent window defroster design
- Auto temperature adjust kit for aggressive area
- High precision wiper , support user-defined
- Fit for various brand cameras
- Wall, pole, ceiling mounted way



CZ100-A



CZ100-B

Application

CZ100-□ is a ZUOAN designed classic explosion-proof camera, which can load various camera. The explosion proof camera can apply for Zone 1 and Zone 2 hazardous areas that explosive mixture of group IIA, IIB, IIC, T1~T6 gases, vapors and air may exist, Zone 21 and Zone 22 hazardous areas that explosive dust may exist. It's applicable for refining and chemical industry, oil extraction, gas production, fireworks production, grain production and storage, petrol station and so on.



Skype: cookee.lee

Tel: 0519-88962115-873

Fax: 0519-88968180

CZ100-□ EXPLOSION PROOF FIXED CAMERA

MECHANICAL

Material: Stainless steel 304/316L
Ingress protection: IP68
Cable glands: M25x1.5, M27x1.25
Cable entry: 2pcs
Dimension: see fig
Weight: CZ100-A, 15.5kg; CZ100-B, 12.5kg.
Mount: wall, pole (or customer tailored)

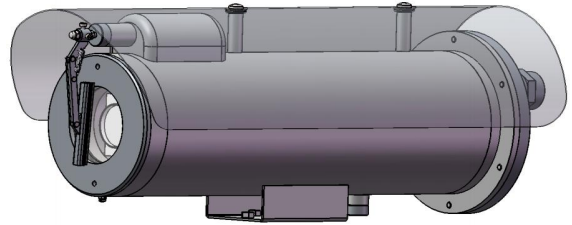



CZ100-A

ELECTRICAL

Voltage: 100~240V AC or 24V AC; Max. 1.5A
Power: ≤36W (without heat, fan)

EX-PROOF MARKING

Explosion proof marking:

CE 2460  II 2G Ex db op is II C T6 Gb,
 II 2D Ex tb op is IIIC T80 °C Db

Standards: IEC/EN60079

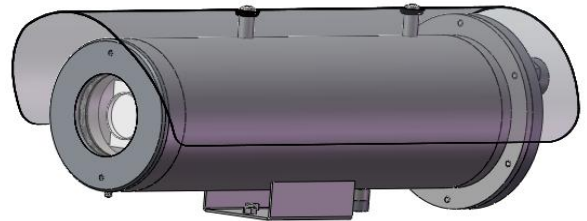

CZ100-B

ENVIRONMENT

Ambient temperature: -40°C~+60°C
Atmosphere pressure: 80kPa~120kPa
Relative humidity: ≤95%RH (+25°C)

ACCESSORIES

Wall Bracket: ZAZ100B
Ex Junction Box: ZA-JXD4
Ex Control Box: CZ300



Skype: cookee.lee

Tel: 0519-88962115-873 Fax: 0519-88968180

 佐安电器
ZUOAN EX-PROOF CCTV

Certificate

ATEX Certificate Mark	  II 2G Ex db op is IIC T6 Gb,  II 2D Ex tb op is IIIC T80 °C Db
Certificate	ATEX, IECEx
Standards	IEC/EN60079

Mechanical

Housing	Stainless steel 304 or 316L
Surface	Optional electro-polish or painting
Ingress protection	IP68 (1.2m/ 45min)
Cable thread hole	M25X1.5, or M27×1.25、

Electrical

Voltage	AC100V~AC240V or AC24V
Power	15W/25W (with thermostat)
Surge Protect	Optional, TVS6000V surge protect
Optical Fiber output	Optional, multimode or single mode
Optical Video signal	1-way video output
Optional network signal	RJ45
Optical Audio	1-way input, 1-way output
Optical Alarm	2-way alarm input, 1-way alarm output
Address code:	0/1
Trail cable	2m integrated cable

Ambient

Ambient temperature	-25°~+60°/-40°~+60°℃
Air pressure	80Kpa to 110Kpa
Relative Humidity	≦95% (no condensation)

Communication

Communication type	RS485
Protocol	Pelco-D, Pelco-P
Communicate Rate	2400~19200bps adjustable
485 Communication	Support

General

Model	CZ100-A	CZ100-B
Sun-shield	Yes	Optional
Wiper	Yes	No
Overall dimension	524*179*215mm	524*179*208mm
Weight	15.5kg	12.5kg

Skype: cookee.lee

Tel: 0519-88962115-873

Fax: 0519-88968180



DAY & NIGHT ANALOG ZOOM CAMERA

Image Sensor	1/3" interline-transfer CCD	
Parameters	23X 1/3" CCD ICR Day/Night Zoom Camera	36X 1/3" CCD ICR Day/Night Zoom Camera
Horizontal resolution	700TVL (color), 720TVL (B&W)	
Effective pixel	PAL 976*582 NTSC 976*494	
Min. Illumination	Color: 0.04Lux @ (F1.6, AGC ON) B/W: 0.004Lux @ (F1.6, AGC ON)	
S/N ratio	>50dB (AGC off)	
Lens		
Focal Length	4-92mm, 23X optical	3.3-119mm, 36X optical
Aperture Range	F1.5-F3.6	F1.6-F4.4
Angle of View	49-2.2 degree(Wide-Tele)	58-1.7 degree(Wide-Tele)
Min. Working Distance	10mm-1500mm(Wide-Tele)	
Zoom Speed	Approx. 3s(Optical, Wide-Tele)	
Day & Night	ICR	
Function		
Focus Mode	Auto/Manual/One touch	
Exposure Mode	Auto/Aperture Priority/Shutter Priority/Manual	
Day & Night Mode	Auto/Color/BW	
Shutter Time	1/50(1/60) sec~ 1/10,000 sec	
White Balance	Auto /Indoor/Outdoor/Manual/auto tracking	
BLC	ON/OFF	
Privacy	Off/on	
Exposure Compensation	10 levels adjustable	
Gain	Auto/manual	
Gain Limitation	16 levels adjustable	
Contrast	8 levels adjustable	
Saturation	8 levels adjustable	
Mirror	Off/no	
Slow shutter	X256 MAX	
Anti-shake	Off/ on	
Digital WDR	ON/OFF, 15 levels adjustable	
Image Setting	Saturation, Brightness, Contrast, Sharpness adjustable	
Lens Initialization	Internal	
External connection	9 Pin FFC	

Skype: cookee.lee

Tel: 0519-88962115-873

Fax: 0519-88968180



DAY & NIGHT NETWORK ZOOM CAMERA

Image Device	1/2.8" Progressive Scan CMOS	
Effective Pixels /Resolution	50HZ:25fps(1920x1080) 60HZ:30fps(1920x1080) 50HZ:25fps(1280x720) 60HZ:30fps(1280x720)	
Optical zoom	20X ,4.7-94mm	30X, 4.5-135mm
Digital Zoom	12X	
Aperture Range	F1.6-F3.5	F1.6-F4.4
Angle of view	61.4-29 degree (wide -tele)	65.1-2.34 degree (wide -tele)
Min. Working distance	10mm-1500mm(wide-tele)	
Zoom speed	Approx 3s (optical, wide-tele)	
Day&night	ICR	
Focus mode	Auto/manual/one touch	
Day&night mode	Auto/color/BW	
Shutter Time	1/1sec-1/30,000 s	
White balance	Auto 1/Auto 2/Indoor/Outdoor/Manual/Sodium Lamp/Fluorescent Lamp	
BLC	ON/OFF	
Exposure compensation	10 levels adjustable	
Gain	16 levels adjustable	
Gain limitation	16 levels adjustable	
DNR	3D DNR	
mirror	support	
Digital WDR	ON/OFF, 15 levels adjustable	
Imaging setting	Saturation, brightness, contrast, sharpness adjustable	
Video compression	H.264 main profile/MJPEG	
Video bit rate	32kbps-16mbps	
Audio compression	G.722.1/G.711-a law/G.711-u law/MP2L2/G.726	
Imaging setting	Zoom camera module function can be adjustable by client software ore web browser	
alarm	Motion detection, tampering alarm, storage full, storage exception	
protocol	TCP/IP, HTTP, DHCP, DDNS, RTP, RTSP, PPPoE, SMTP, NTP, UPnP, SNMP, FTP, 802.1*, QoS, HTTPS, IPv6(SIP, SRTP optional)	
standard	ONVIF, PSIA, CGI, ISAPI	
Communication interface	1 RJ45 10M/100M self-adaptive Ethernet interface, 1 RS-485.	
Video output	Dual core 1Vp-p Composite Output (75Ω)	
Lens value	Distance: 10mm-1500mm(Wide-Tele) Angle: 58.3-3.2 degree(Wide-Tele)	
S/N ratio	More than 52dB	
Minimum illumination	Color: 0.05Lux @ (F1.6, AGC ON) B/W: 0.01Lux @ (F1.6, AGC ON)	

Dimension

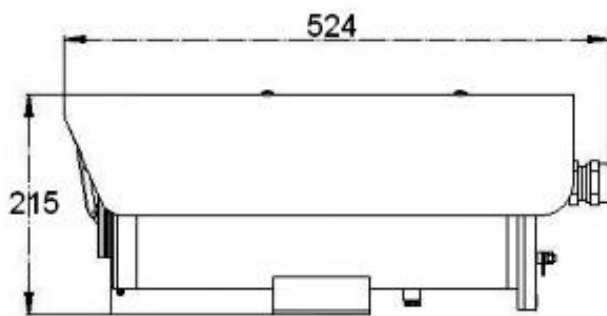

CZ100-A

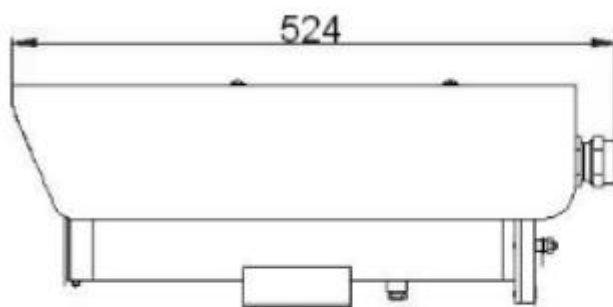
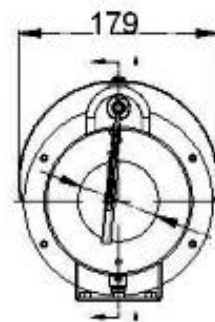

CZ100-B

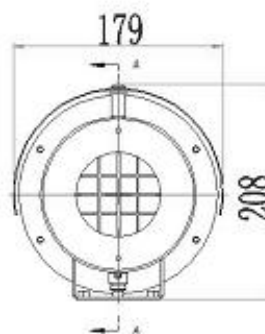
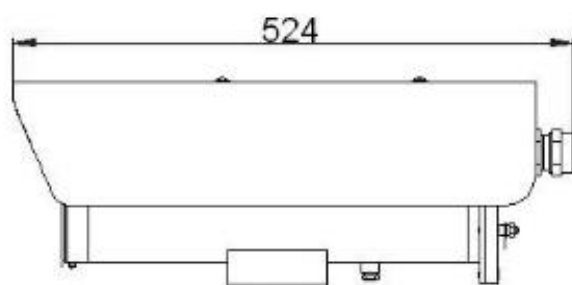
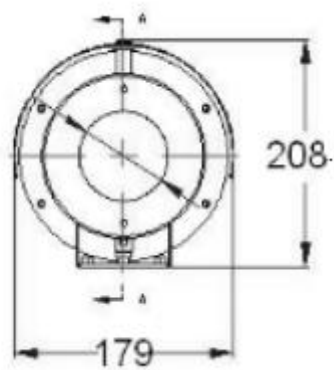

Relatives



Ex Housing for thermal camera

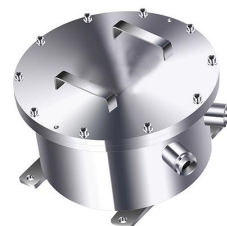

CZ300 Ex Control Box



ZAZ100B Wall bracket with mount adapter

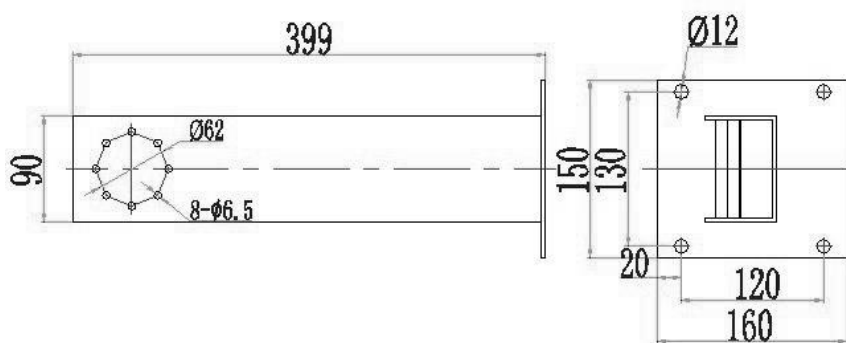

Wall bracket

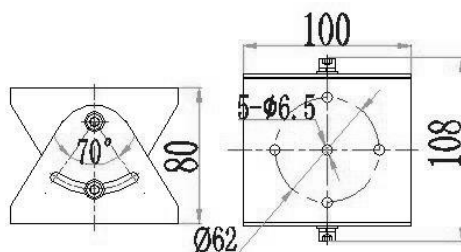

Mount adapter